

# REGMATIC

## 5/2 Way Namur Mount Solenoid Valve Series 20

Figure No	Voltage
20024AC	24 V AC
20110AC	110 V AC
20220AC	220 V AC
20024DC	24VDC
20048DC	48 V DC
20110DC	110 V DC

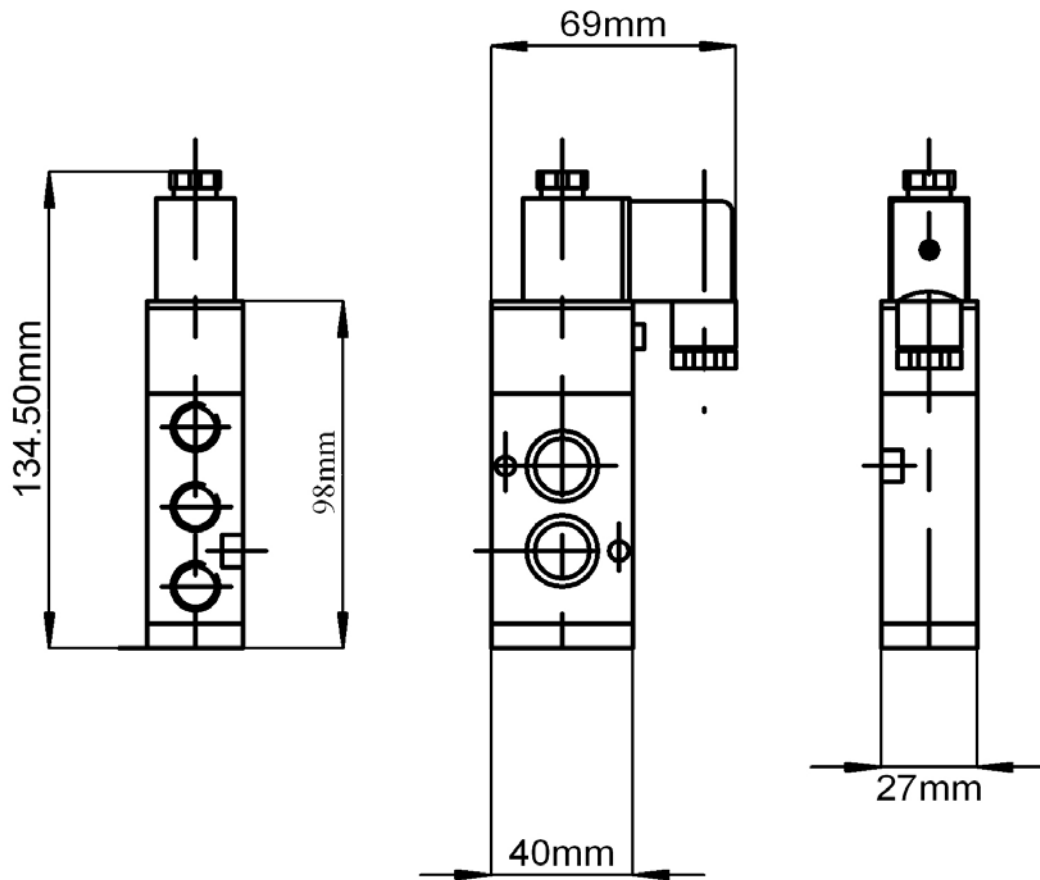

### Technical data:

Protection class IP 65  
 Relative duty cycle 100 %  
 Voltage tolerance +/-10 %

Working pressure 1.5-8Bar  
 Area/ Flow coefficient 14 mm<sup>2</sup>, cv = 0.78  
 Power consumption AC = 5.5 VA, DC = 4.8 W

Approvals by ATEX, CSA and UL

Can also be supplied with coils for EEx ia 11 T6 and T4 and  
 EEx m 11 T4

***CeeVee Ltd***

Units E7 & E8  
 Inchbrook Trading Estate, Woodchester,  
 Stroud, Glos. GL5 5EY  
 Tel 01453 833148 info@cee-vee.co.uk